



SUMMIT WOODS CROSSING PAD BUILDING

FRONT PAD BUILDING SPACE AVAILABLE FOR LEASE

50 Highway & Chipman Road (NWQ), Lee's Summit, MO



LEASE RATE: \$35/SF NNN | 1,565 SF SPACE

DEMOGRAPHICS

	1 mile	3 miles	5 miles
Estimated Population	4,486	39,552	109,347
Avg. Household Income	\$73,246	\$90,357	\$91,205

- 1,565 SF end cap former frozen yogurt shop - FOR LEASE
- 735,000 SF Summit Woods Crossing shopping center
- Building has Buffalo Wild Wings and Sports Clips
- Fantastic growth area, with good signage, access, and visibility
- Join Lowe's, Best Buy, Kohl's, Target, Dick's Sporting Goods, Bed Bath & Beyond, Michaels, Old Navy, TJ Maxx, Ulta, Petco, and many others
- Intersection carries over 148,000 cars per day

 [CLICK HERE TO VIEW MORE LISTING INFORMATION](#)

For More Information Contact: *Exclusive Agents*
 DAVID BLOCK | 816.412.7400 | dblock@blockandco.com
 ALEX BLOCK | 816.412.7373 | ablock@blockandco.com





Summit Woods Crossing Pad Building

FRONT PAD BUILDING SPACE AVAILABLE FOR LEASE
50 Highway & Chipman Road (NWQ), Lee's Summit, MO

1,565 SF END CAP RESTAURANT SPACE

PAD 3 PHOTOS - 1,565 SF END CAP RESTAURANT SPACE





Summit Woods Crossing Pad Building

FRONT PAD BUILDING SPACE AVAILABLE FOR LEASE
50 Highway & Chipman Road (NWQ), Lee's Summit, MO

**1,565 SF END CAP
RESTAURANT
SPACE**

PAD 3 SITE PLAN

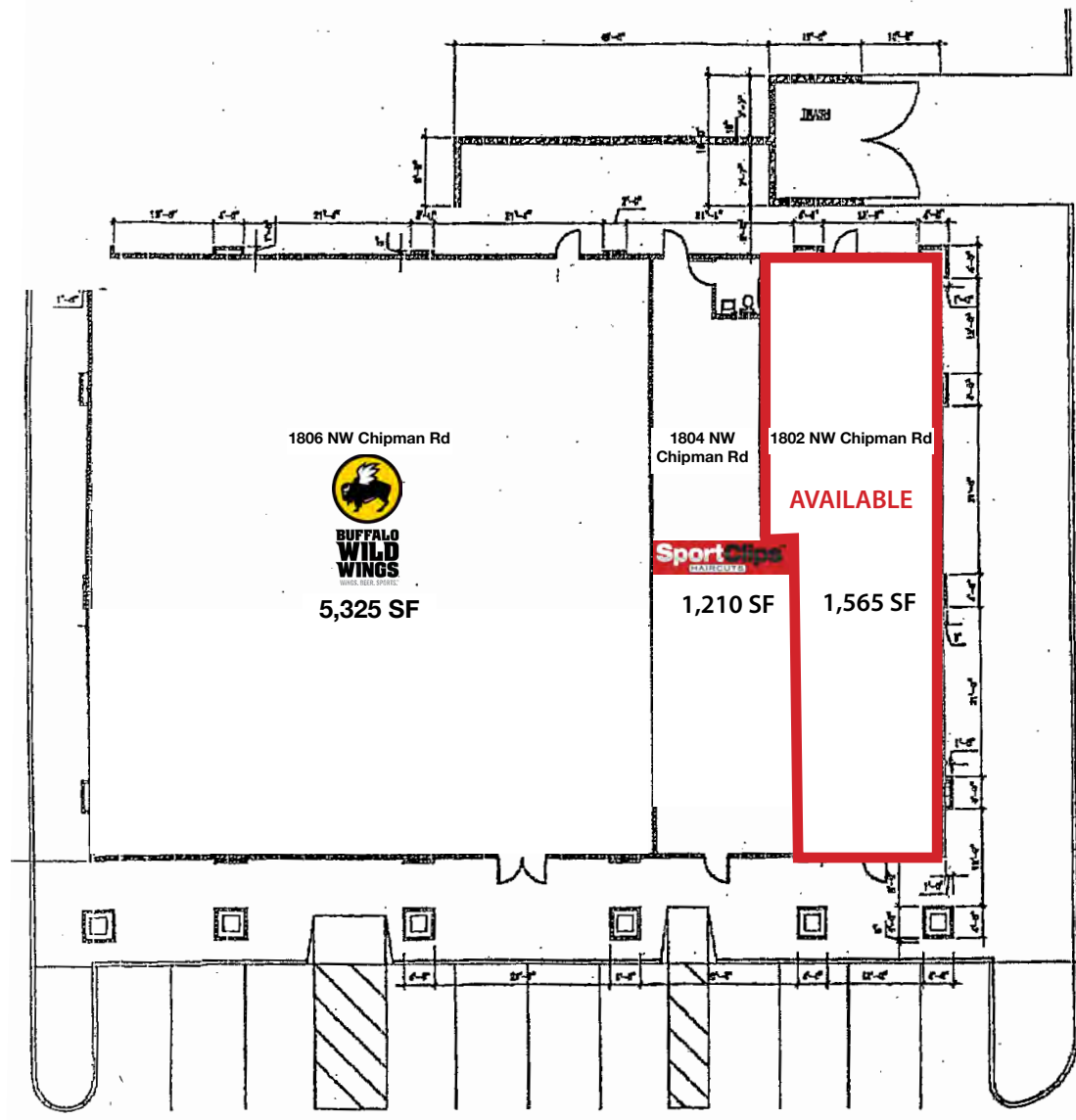



Summit Woods Crossing Pad Building

FRONT PAD BUILDING SPACE AVAILABLE FOR LEASE
50 Highway & Chipman Road (NWQ), Lee's Summit, MO

**1,565 SF END CAP
RESTAURANT
SPACE**

SUMMIT WOODS PAD SITE PHOTOS





Summit Woods Crossing Pad Building

FRONT PAD BUILDING SPACE AVAILABLE FOR LEASE
50 Highway & Chipman Road (NWQ), Lee's Summit, MO

1,565 SF END CAP RESTAURANT SPACE

OVERALL SHOPPING CENTER PLAN





Summit Woods Crossing Pad Building

FRONT PAD BUILDING SPACE AVAILABLE FOR LEASE
50 Highway & Chipman Road (NWQ), Lee's Summit, MO

1,565 SF END CAP RESTAURANT SPACE

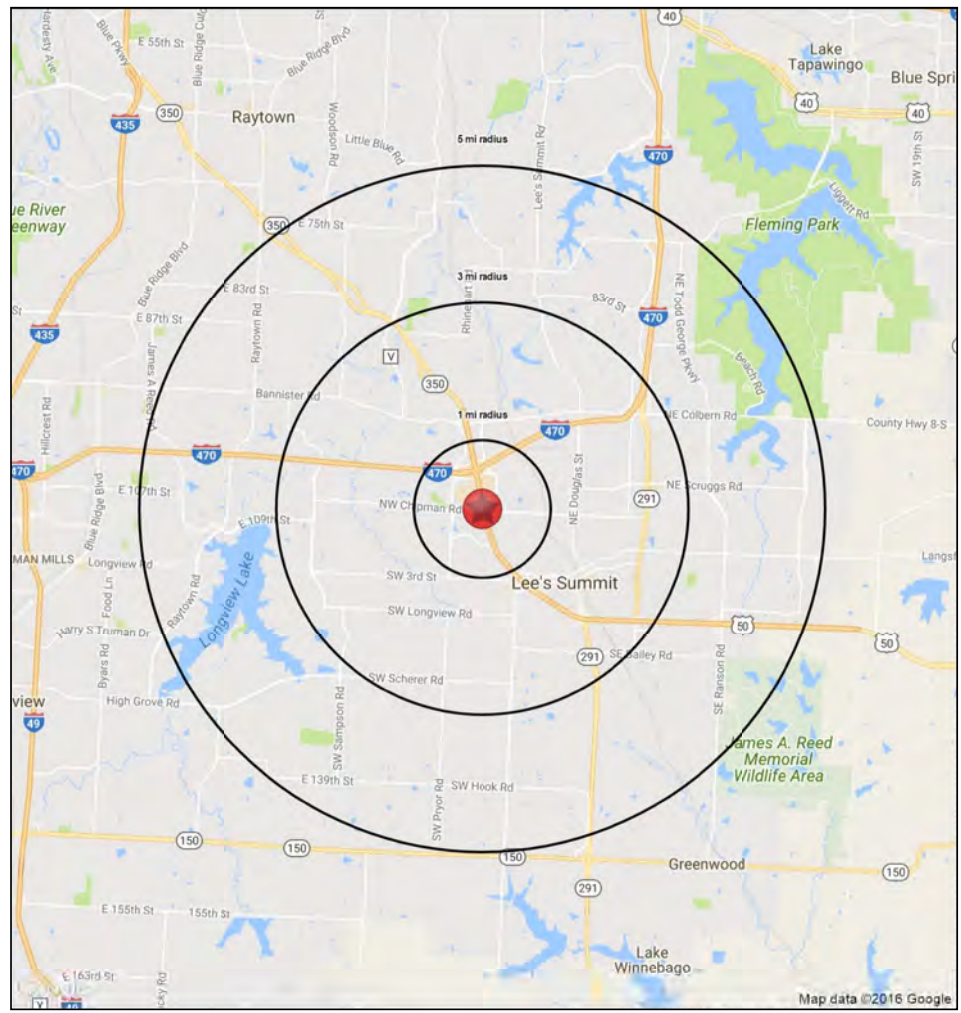
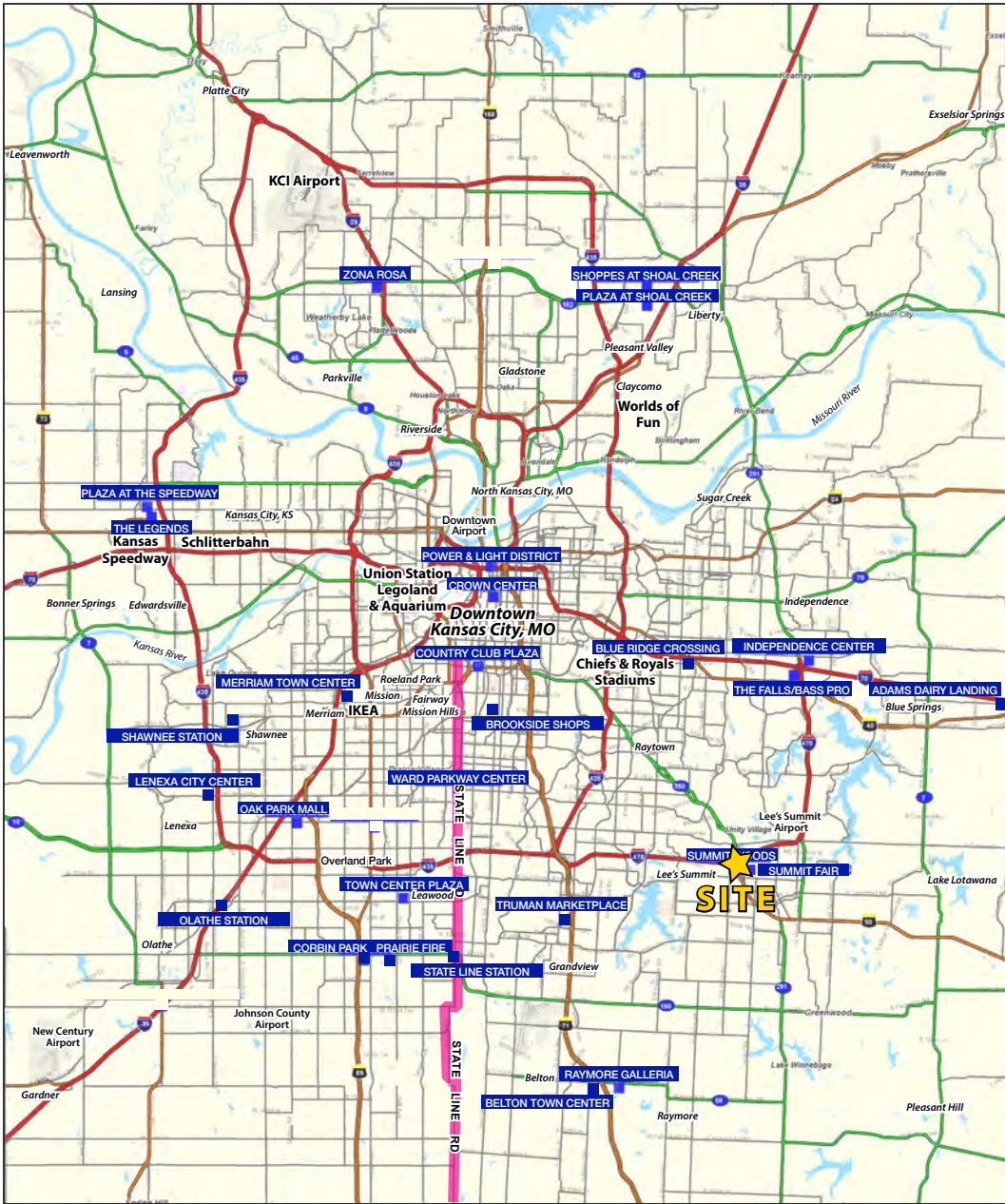

All information furnished regarding property for sale or lease is from sources deemed reliable, but no warranty or representation is made as to the accuracy thereof and the same is subject to errors, omissions, changes of prices, rental or other conditions, prior sale or lease or withdrawal without notice.



Summit Woods Crossing Pad Building

FRONT PAD BUILDING SPACE AVAILABLE FOR LEASE

50 Highway & Chipman Road (NWQ), Lee's Summit, MO

50 Highway & Chipman Road

Lee's Summit, MO 64081

1 mi radius 3 mi radius 5 mi radius

		1 mi radius	3 mi radius	5 mi radius
POPULATION	2020 Estimated Population	4,486	39,552	109,347
	2025 Projected Population	4,596	39,881	109,773
	2010 Census Population	3,568	36,340	104,799
	2000 Census Population	4,014	31,394	93,722
	Projected Annual Growth 2020 to 2025	0.5%	0.2%	-
	Historical Annual Growth 2000 to 2020	0.6%	1.3%	0.8%
	2020 Median Age	53.0	40.1	38.2
HOUSEHOLDS	2020 Estimated Households	2,377	17,275	44,275
	2025 Projected Households	2,368	17,060	43,719
	2010 Census Households	1,774	14,938	40,171
	2000 Census Households	1,768	13,005	35,825
	Projected Annual Growth 2020 to 2025	-	-0.2%	-0.3%
	Historical Annual Growth 2000 to 2020	1.7%	1.6%	1.2%
RACE AND ETHNICITY	2020 Estimated White	87.7%	83.0%	73.9%
	2020 Estimated Black or African American	6.7%	9.9%	18.9%
	2020 Estimated Asian or Pacific Islander	2.0%	2.1%	2.0%
	2020 Estimated American Indian or Native Alaskan	0.3%	0.4%	0.4%
	2020 Estimated Other Races	3.3%	4.6%	4.9%
	2020 Estimated Hispanic	3.8%	4.9%	5.1%
INCOME	2020 Estimated Average Household Income	\$73,246	\$90,357	\$91,205
	2020 Estimated Median Household Income	\$66,427	\$76,556	\$75,701
	2020 Estimated Per Capita Income	\$38,910	\$39,551	\$36,994
EDUCATION (AGE 25+)	2020 Estimated Elementary (Grade Level 0 to 8)	0.9%	1.5%	1.4%
	2020 Estimated Some High School (Grade Level 9 to 11)	2.9%	3.0%	3.1%
	2020 Estimated High School Graduate	27.3%	22.5%	24.3%
	2020 Estimated Some College	20.7%	23.2%	25.0%
	2020 Estimated Associates Degree Only	8.2%	8.9%	8.3%
	2020 Estimated Bachelors Degree Only	24.0%	25.4%	23.2%
	2020 Estimated Graduate Degree	16.1%	15.4%	14.5%
BUSINESS	2020 Estimated Total Businesses	466	2,313	4,009
	2020 Estimated Total Employees	10,935	33,152	49,500
	2020 Estimated Employee Population per Business	23.5	14.3	12.3
	2020 Estimated Residential Population per Business	9.6	17.1	27.3

